

SPARE PART CATALOGUE | TSXC 125 SW TSXC 140 BW

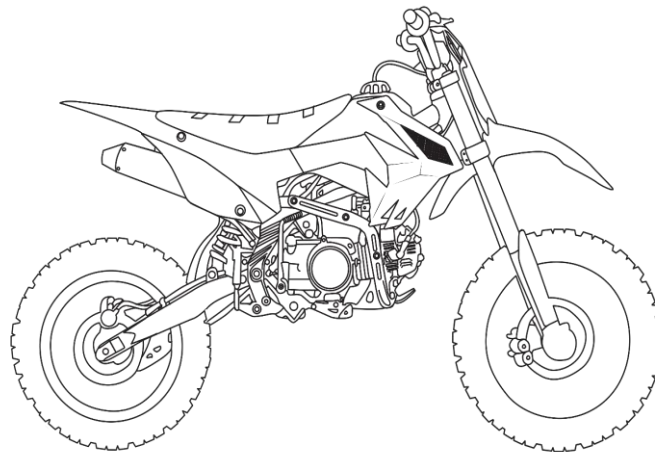

ENGINE

ENGINE YX 140 and 125 SW

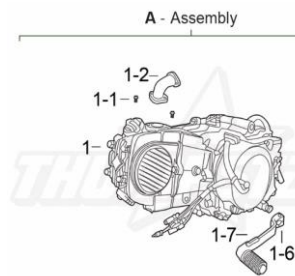

POS.	PART NO	ERP CODE	ENGLISH NAME	QTY
A	3594		140cc Complete Assembly	
A	3192		125cc Complete Assembly	
TSX 140 BW				
1			YX 140cc kick start engine	1
TSX 125 SW				
1		W.125.114 0	YX 125cc kick start engine	1
For all models				
1-1		7.010.0030	M6 x 20M Hexagonal Flange Bolt	4
1-2		1.004.0060	26 mm Manifold	1
1-6		7.020.0010	M6 x 15M Hexagonal Flange Bolt	2
1-7		1.001.0090	12 mm Gear Lever	1

COMPLETE TOP END

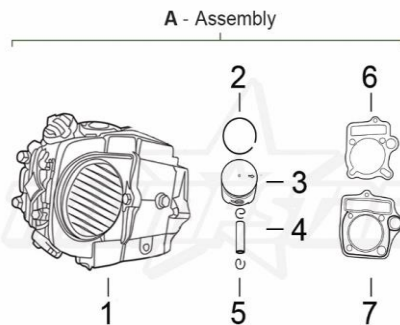

POS.	PART NO	ERP CODE	ENGLISH NAME	QTY
A	3592		YX 125 Complete Assembly	
A	3593		YX 140 Complete Assembly	
1		1.057.0052 1.059.0062	Top End	1
2		1.102.0053	Piston's Ring	
3		1.101.0051	Piston	1
4		1.103.0042	Gadient Pin	1
5		1.104.0051	Gadient Pin lips	2
6		1.058.0013	Head Gasket	1
7			Base Gasket	1

CARBURETOR

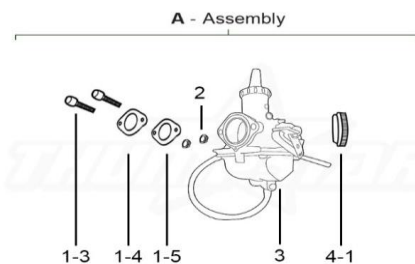

POS.	PART NO	ERP CODE	ENGLISH NAME	QTY
A			Complete Assembly	
TSX 140 BW				
3	957	1.016.0190	Mikuni VM-26 Carburator	1
TSX 125 SW				
3		1.016.0170	Mikuni VM-22 Carburator	1
For all models				
1-4		1.008.0020	Paper Manifold Pad	1
1-5		1.007.0020	Plastic Manifold Gasket	1
1-3		7.010.0050	M6 x 30M Hexagonal Flange Bolt	2
2		7.150.0010	M6 Hexagonal Locknut	2
4-1		1.030.0040	38-57 mm Hose Clamp	1

AIR FILTER		POS.	PART NO	ERP CODE	ENGLISH NAME	QTY		
		A	3004		42mm Complete Assembly			
		A	3110		38mm Complete Assembly			
		TSX 140 BW						
		4		1.027.0061		42mm Air Filter	1	
		TSX 125 SW						
		4		1.027.0041		38mm Air Filter	1	
		For all models						
		4-1		1.030.0040		38-57 mm Hose Clamp	1	
		4-2				Mesh	1	
STATOR GUARD		POS.	PART NO	ERP CODE	ENGLISH NAME	QTY		
		A	3560		Complete Assembly			
		5		7.140.0020		M8 Hexagonal Locknut	2	
		6		3.330.0180		Φ9 x Φ20 x 11 mm Engine pallet bushings	1	
		7		7.220.0020		Φ8 mm Spring Washer	2	
		8		7.210.0080		Φ8 x Φ16 mm Flat washer	2	
		9		7.010.0300		M8 x 125M Hexagonal Flange Bolt	1	
		10		7.010.0270		M8 x 105M Hexagonal Flange Bolt	1	
		11		7.070.0040		M6 x 10M Hexagon Socket Head Cap Screws	2	
		12	3518	1.137.0110		Left Engine Cover	1	
		13	3518			CNC Stator Guard		
		14	3561			Plastic Sprocket Cover		
		KICK START		POS.	PART NO	ERP CODE	ENGLISH NAME	QTY
				13	3562	1.002.0110	16 mm Kick Start Lever	1
MUFFLER		POS.	PART NO	ERP CODE	ENGLISH NAME	QTY		
		A	3005		Complete Assembly			
		1		7.140.0010		M6 Hexagonal Locknut	2	
		2	3356	1.087.0010		Exhaust Pipe Gasket	1	
		3	3355	1.086.0230		Exhaust Pipe	1	
		4		1.081.0040		Heat Resistant Film	1	
		4-1		7.060.0020		M6 x 10M Hexagon Socket Head Cap Screws	2	
		4-2		7.220.0010		Φ6 mm Spring Washer	2	
		4-3		7.210.0040		Φ6 x Φ12 mm Flat Washer	2	
		5		1.087.0045		Exhaust Pipe Seal	1	
		6	3354	1.085.0210		Muffler	1	
		7		7.010.0150		M8 x 30M Hexagonal Flange Bolt	1	
		8		7.210.0090		Φ8 x Φ22 mm Flat Washer	1	
		9		7.220.0020		Φ8 mm Spring Washer	1	
		10		1.089.0040		Clamp	1	
TRIPLE CLAMP SYSTEM								
BAR / FORK CLAMPS		POS.	PART NO	ERP CODE	ENGLISH NAME	QTY		
		A	3008		Complete Assembly	方向器总成		
		1	3480	4.090.0100		Bar Clamp Raisers	2	
		2	3482	4.080.0120		Bar Clamp	2	
		3	3343	7.260.0020		Steering stem Nut	1	
		4		7.210.0270		Φ23 x Φ35 mm Flat Washer	1	
		5		7.070.0210		M8 x 90M Hexagon Socket Head Cap Screws	4	
		6		7.140.0020		M8 Hexagonal Locknut	4	
		7	3480	4.060.0100		Upper Fork Clamp	1	
		8	3241	7.270.0030		Alien nut	1	
		9	3481	4.100.0040		Steering Axle	1	
		10	3344	7.350.0050		Steering Bearing	1	
		11	3482	4.070.0090		Lower Fork Clamp	1	
		12		7.110.0030		M5 x 12M Crossed Round Headed Screw	1	
		13	3065	7.430.0050		Buckle	1	
		14		7.070.0140		M8 x 16M Hexagon Socket Head Cap Screws	2	
		15		7.220.0020		Φ8 mm Spring Washer	2	
		16	3243	7.350.0040		Taper bearings		

STEERING HEAD BEARING		POS.	PART NO	ERP CODE	ENGLISH NAME	QTY
<p>A - Assembly</p> <p>8 16 10</p>		A			Complete Assembly	
		8	3241	7.270.0030	Shaped nut	1
		10	3344	7.350.0050	Steering Bearing	1
		16	3243	7.350.0040	Φ22 x Φ14 mm (320-22) Taper Bearing	1

FRAME SYSTEM

FRAME		POS.	PART NO	ERP CODE	ENGLISH NAME	QTY		
<p>1</p>		1	3121	3.500.0383	Frame	1		

FRAME ASSEMBLY PARTS		POS.	PART NO	ERP CODE	ENGLISH NAME	QTY
<p>A - Assembly</p> <p>2 3 4 5 6 7 8 9 10 11 12 13 14 15 16 17 18 19</p>		A	3563		Complete Assembly	
		2		3.730.0021	Side Plastic Mount (left)	1
		3		7.140.0010	M6 Hexagonal Locknut	3
		4		7.210.0070	Φ6 x Φ18 x 1.5 mm Flat Washers	2
		5		7.010.0030	M8 x 20M Hexagonal Flange Bolt	2
		6	3517	6.250.0020	Plastic parts plug	4
		7		3.730.0022	Side Plastic Mount (right)	1
		8		3.330.0180	9 x Φ20 x 11 mm Engine Pallet Bushin	4
		9		7.220.0020	Φ8 Spring Washer	4
		10		7.210.0080	Φ8 x Φ16 Flat Washer	4
		11		7.070.0180	M8 x 35M Hexagon Socket Head Cap Screws	4
		14	3066	3.550.0022	Shock Guard Mounting Plate	1
		15		7.070.0170	M8 x 30M Hexagon Socket Head Cap Screws	4
		16	3060	3.720.0030	Rear Mud Guard Plastic Mount	1
		17		7.010.0010	M6 x 12M Hexagonal Flange Bolt	2
		19	3061	1.017.0080	Fuel Tank Mounting Plate	1

BASH PLATE		POS.	PART NO	ERP CODE	ENGLISH NAME	QTY
<p>A - Assembly</p> <p>12 3 5 13</p>		A	3564		Complete Assembly	
		13	3002	3.540.0051	Bash plate	1
		12		7.010.0020	M6 x 16M Hexagonal Flange Bolt	5
		3		7.140.0010	M6 Hexagonal Locknut	3
		5		7.010.0030	M6 x 20M Hexagonal Flange Bolt	2

FRAME SPARE PARTS

BRAKE PEDAL		POS.	PART NO	ERP CODE	ENGLISH NAME	QTY
<p>A - Assembly</p> <p>1 2 3 4 5 6 7 8 9 10 11 12</p>		A	3025		Complete Assembly	
		1	3523	4.260.0192	Foot brake pedal	1
		2		7.120.0210	M8 x 40M Hexagon Socket Semi Circular Head Screws	1
		3	3527	7.390.0010	Fully sealed bearing	4
		4	3362	7.210.0110	Φ9 x Φ17 x 2.5 mm Flat Washer	1
		5		7.160.0040	M8 Hexagonal Locknut	2
		6	3526	7.440.0010	Rear brake Adjuster Cam	1
		7		7.070.0060	M6 x 16M Hexagon Socket Head Cap Screws	2
		8		7.150.0010	M6 Hexagonal Locknut	1
		9	3363	4.280.0030	Foot brake pedal head	1
		10	3524	4.270.0050	Foot brake lever spring	1
		11		7.120.0170	M6 x 14M Hexagon Socket Semi Circular Head Screws	1
12	3073	4.430.0010	Brake Piston	1		

REAR SUBFRAME		POS.	PART NO	ERP CODE	ENGLISH NAME	QTY
<p>A - Assembly</p>		A	3568		Complete Assembly	
		27		7.010.0140	M8 x 25M Hexagonal Flange Bolt	4
		28		3.330.0070	Φ8 x Φ14 x 13 Spacer	4
		29	3021	3.640.0012	rear subframe	1

SWINGARM SYSTEM

SWINGARM ASSEMBLY		POS.	PART NO	ERP CODE	ENGLISH NAME	QTY
<p>A - Assembly</p>		A	3569		Complete Assembly	
		1	3529	7.390.0100	Fully sealed bearing	2
		3		3.330.0311	Φ12 x Φ22 x 19 mm Bearing Spacer	2
		4		3.320.0010	Φ12 x 210 x M12 x 1.25 Swingarm Axle	1
		8		7.140.0040	M12 x 1.25M Hexagonal Locknut	1

SWINGARM		POS.	PART NO	ERP CODE	ENGLISH NAME	QTY	
<p>2</p>		2	3513	3.510.0450	12/14" Swing Arm	1	

CHAIN SLIDER		POS.	PART NO	ERP CODE	ENGLISH NAME	QTY
<p>A - Assembly</p>		A	3570		Complete Assembly	
		5	3034	3.350.0010	Chain Slider	1
		6	3361	3.350.0060	Oval Stepwasher	2
		7		7.090.0040	M6 x 16M Cross Head Recessed Countersunk Screw	4

CHAIN GUIDE		POS.	PART NO	ERP CODE	ENGLISH NAME	QTY
<p>A - Assembly</p>		A	3035		Complete Assembly	
		9-1		2.080.0010	Chain Guide Spacer	2
		9		2.100.0060	Chain Guide	1
		10		7.010.0171	M8 x 45M Hexagonal Flange Bolt	2

BRAKE LEVER		POS.	PART NO	ERP CODE	ENGLISH NAME	QTY		
		A	3575		Complete Assembly			
		6		7.010.0030	M6 x 20M Hexagonal Flange Bolt	2		
		7		7.140.0010	M6 Hexagonal Locknut	2		
		12-2		4.310.0111	Brake Lever	1		
FRONT DRIVING SYSTEM								
BRAKE PADS		POS.	PART NO	ERP CODE	ENGLISH NAME	QTY		
		A	3576		Complete Assembly			
		12-1	3544	4.450.0090	Brake Pads	1 set		
		13			Spring			
		13-1			bolts			
FRONT WHEEL ASSEMBLY								
FRONT WHEEL ASSEMBLY		POS.	PART NO	ERP CODE	ENGLISH NAME	QTY		
		A	3578		17" Complete Assembly			
		A	3577		14" Complete Assembly			
		TSX 140 BW						
		1	3046	3.070.0281	17" Front Rim and Hub Set	1		
		1-1		3.020.0610	17" Rim	1		
		1-2		3.050.0030	Spiral nuts	32		
		1-3		3.040.0041	Spokes	16		
		1-3		3.040.0040	Spokes	16		
		TSX 125 SW						
		1	3115	3.070.0175	14" Front Rim and Hub Set	1		
		1-1		3.020.0270	14" Rim	1		
		1-2		3.050.0030	Spiral nuts	32		
		1-3			Spokes	16		
		1-3			Spokes	16		
		For all models						
		1-4		3.010.0010	Hub core	1		
		1-5		7.390.0110	Fully enclosed bearings	2		
		5		7.140.0050	All-metal hexagonal flange lock nuts	1		
		6		3.130.0422	Axle with hole for split pin	1		
		7		3.330.0620	Right Wheel Spacer	1		
8		3.330.0660	Left Wheel Spacer	1				
9		3.030.0050	Protector	1				
FRONT TIRE ASSEMBLY								
FRONT TIRE ASSEMBLY		POS.	PART NO	ERP CODE	ENGLISH NAME	QTY		
		A	3574		17" Complete Assembly			
		A	3579		14" Complete Assembly			
		TSX 140 BW						
		2		3.090.0270	17" Dirt Tire	1		
		2-1		3.090.0900	17" Inner Tube	1		
		TSX 125 SW						
2		3.090.0250	14" Dirt Tire	1				
2-1		3.090.0900	14" Inner Tube	1				

